

SALE DRAWING - PARCELS 1 THROUGH 4

IN THE CITY OF CANTON, LINCOLN COUNTY, SOUTH DAKOTA



LEGEND

- PROPOSED PROPERTY LINE
- EXISTING PROPERTY LINE
- EXISTING R/WAY LINE
- FOUND MONUMENT
- EASEMENT (AS NOTED)

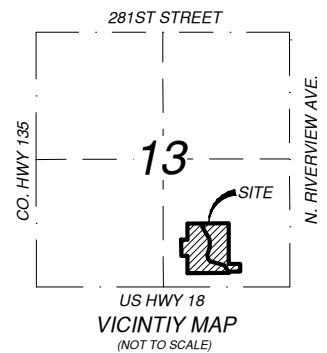
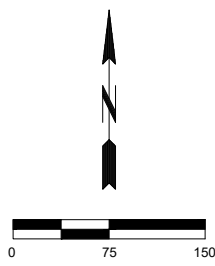

SURVEYOR'S NOTES:

1. BASIS OF BEARING IS SD STATE PLANE, SOUTH ZONE.
2. ALL DISTANCES ARE GROUND DISTANCES.
3. THIS MAP WAS PREPARED WITHOUT THE BENEFIT OF A TITLE COMMITMENT.

PARCEL DESCRIPTIONS AND AREAS:

PARCEL 1: A PORTION LOT 2 IN LEMS ADDITION TO THE CITY OF CANTON, AND A PORTION OF LEMS TRACT 1 TO THE CITY OF CANTON, LINCOLN COUNTY, SOUTH DAKOTA. CONTAINING 5.01 ACRES ±.

PARCEL 2: A PORTION LOT 2 IN LEMS ADDITION TO THE CITY OF CANTON, AND A PORTION OF LEMS TRACT 1 TO THE CITY OF CANTON LINCOLN COUNTY, SOUTH DAKOTA. CONTAINING 7.47 ACRES ±.

PARCEL 3: A PORTION LOT 2 IN LEMS ADDITION TO THE CITY OF CANTON, LINCOLN COUNTY, SOUTH DAKOTA. CONTAINING 8.48 ACRES ±.

PARCEL 4: THE SOUTH 160' OF THE NORTH 1000' OF THE WEST 236' OF THE EAST 1260' IN THE SOUTHEAST QUARTER OF THE SOUTHEAST QUARTER (SE1/4 SE1/4) OF SECTION 13, T 98 N, R 49 W OF THE 5TH P.M., TO THE CITY OF CANTON, LINCOLN COUNTY, SOUTH DAKOTA. CONTAINING 0.87 ACRES ±.

PREPARED BY:

infrastructure
 design group, inc.

116 W. 69TH STREET SUITE 200
 SIOUX FALLS, SD 57108
 PHONE: 605-271-5527
 WEB: infrastructureedg.com

SALE DRAWING - PARCELS 1 THROUGH 4
 IN THE CITY OF CANTON, LINCOLN COUNTY, SOUTH DAKOTA

PROJ. NO.: 23065

DATE: 06/23/2023

DRAWN BY: MAS

CHECKED BY: BMK

SHEET NO: 1 OF 1